

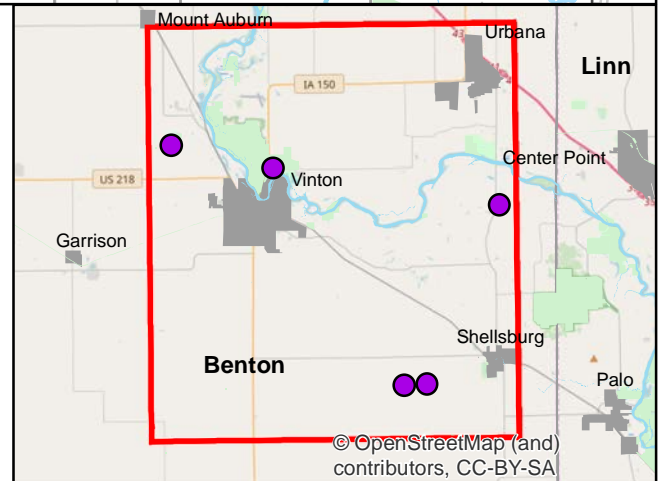

# Volunteer Wildlife Monitoring Program (VWMP) Frog and Toad Survey

Route ID: 159 County: Benton

Click for Google Maps to Site 1: <https://www.google.com/maps/dir/?api=1&destination=42.1853619027,-92.0145953427>

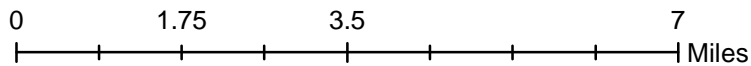
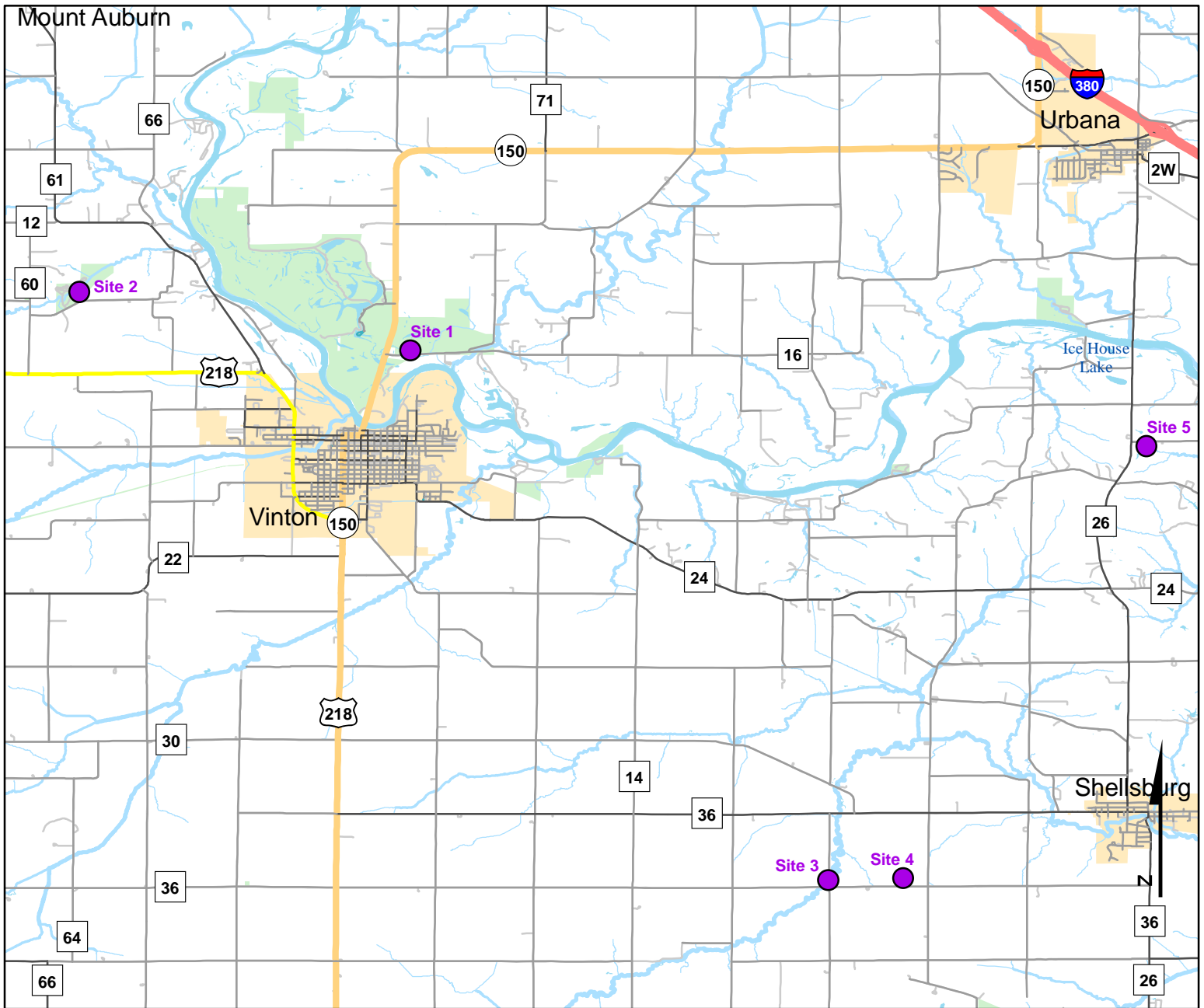



# Volunteer Wildlife Monitoring Program (VWMP) Frog

Route ID: 159 County: Benton

Click for Google Maps to Site 1: <https://www.google.com/maps/dir/?api=1&destination=42.1853619027,-92.0145953427>

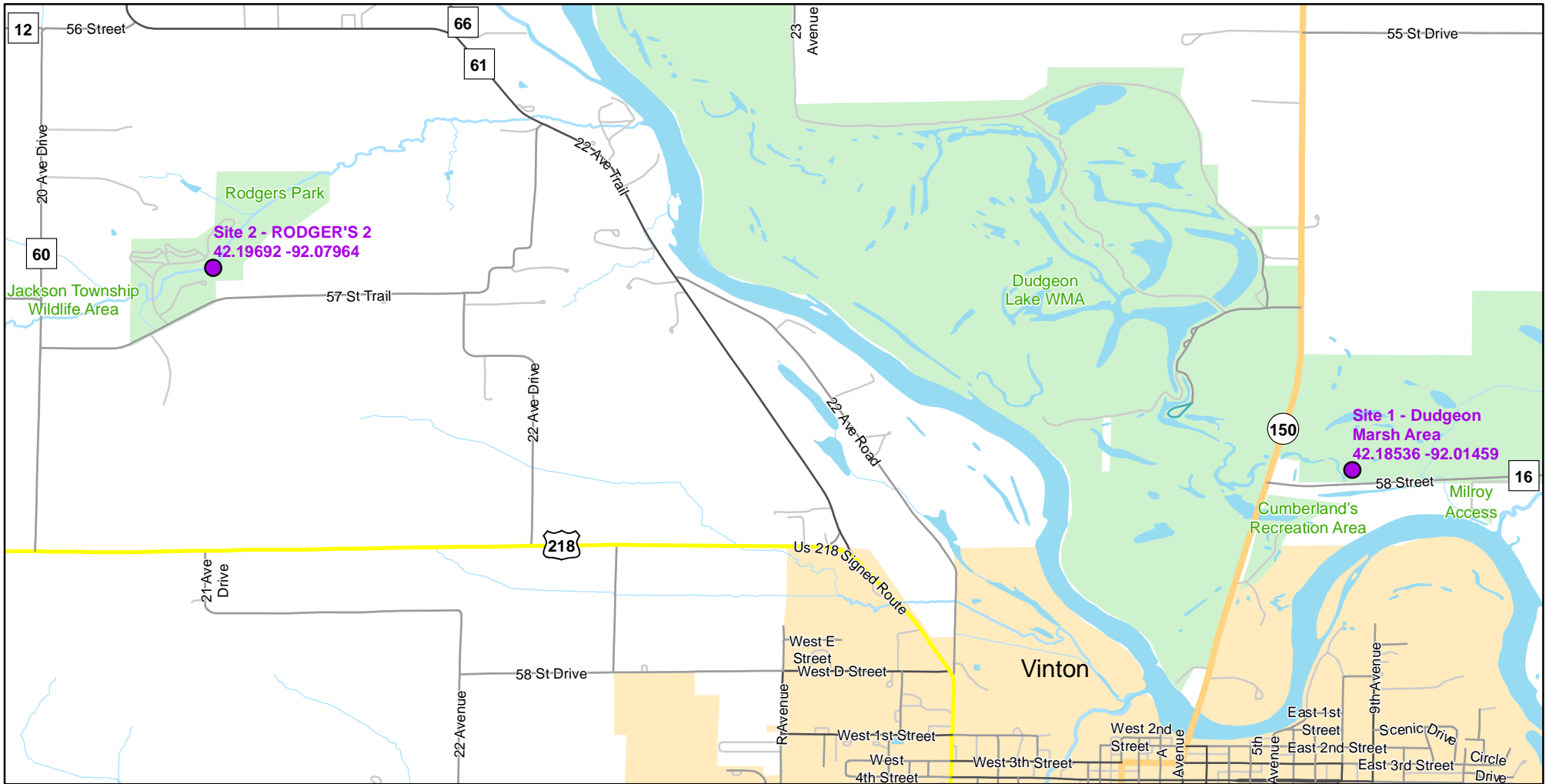

Enlarged View of Site 1

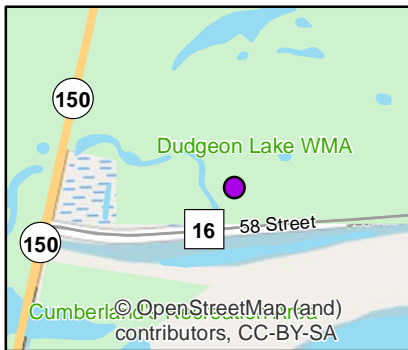

## Legend

----- Trails

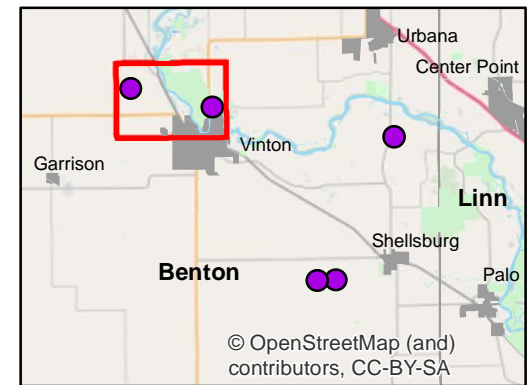
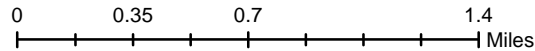



# Volunteer Wildlife Monitoring Program (VWMP) Frog and Toad Survey

Route ID: 159 County: Benton

Click for Google Maps to Site 1: <https://www.google.com/maps/dir/?api=1&destination=42.1853619027,-92.0145953427>

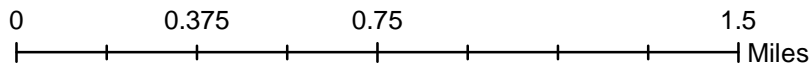
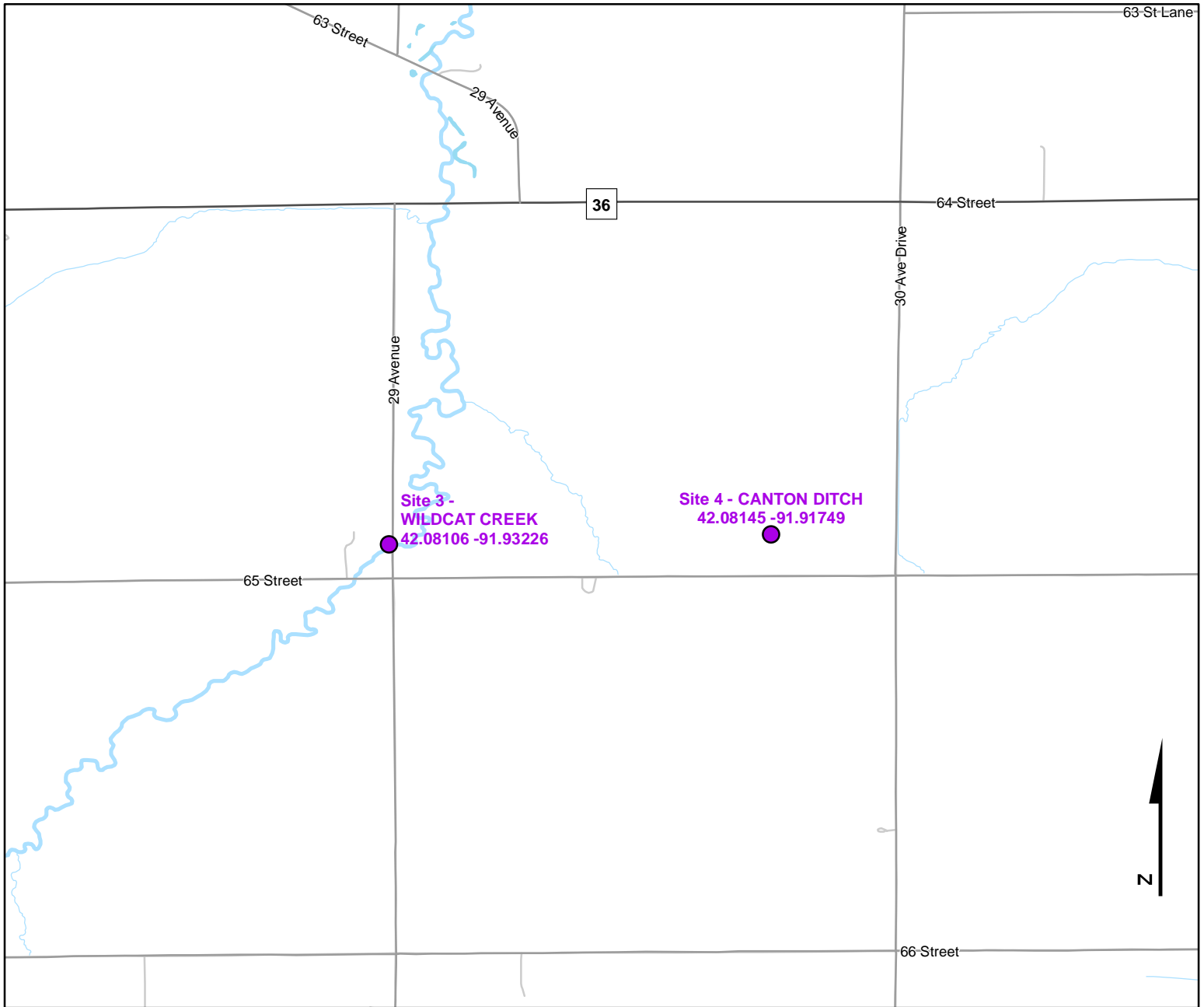

## Legend

----- Trails

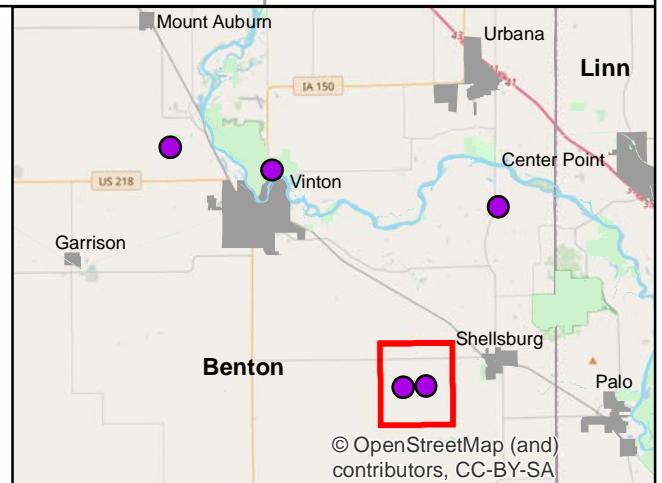

© OpenStreetMap (and contributors, CC-BY-SA)



# Volunteer Wildlife Monitoring Program (VWMP) Frog and Toad Survey

Route ID: 159 County: Benton

Click for Google Maps to Site 1: <https://www.google.com/maps/dir/?api=1&destination=42.1853619027,-92.0145953427>

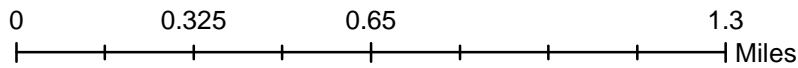
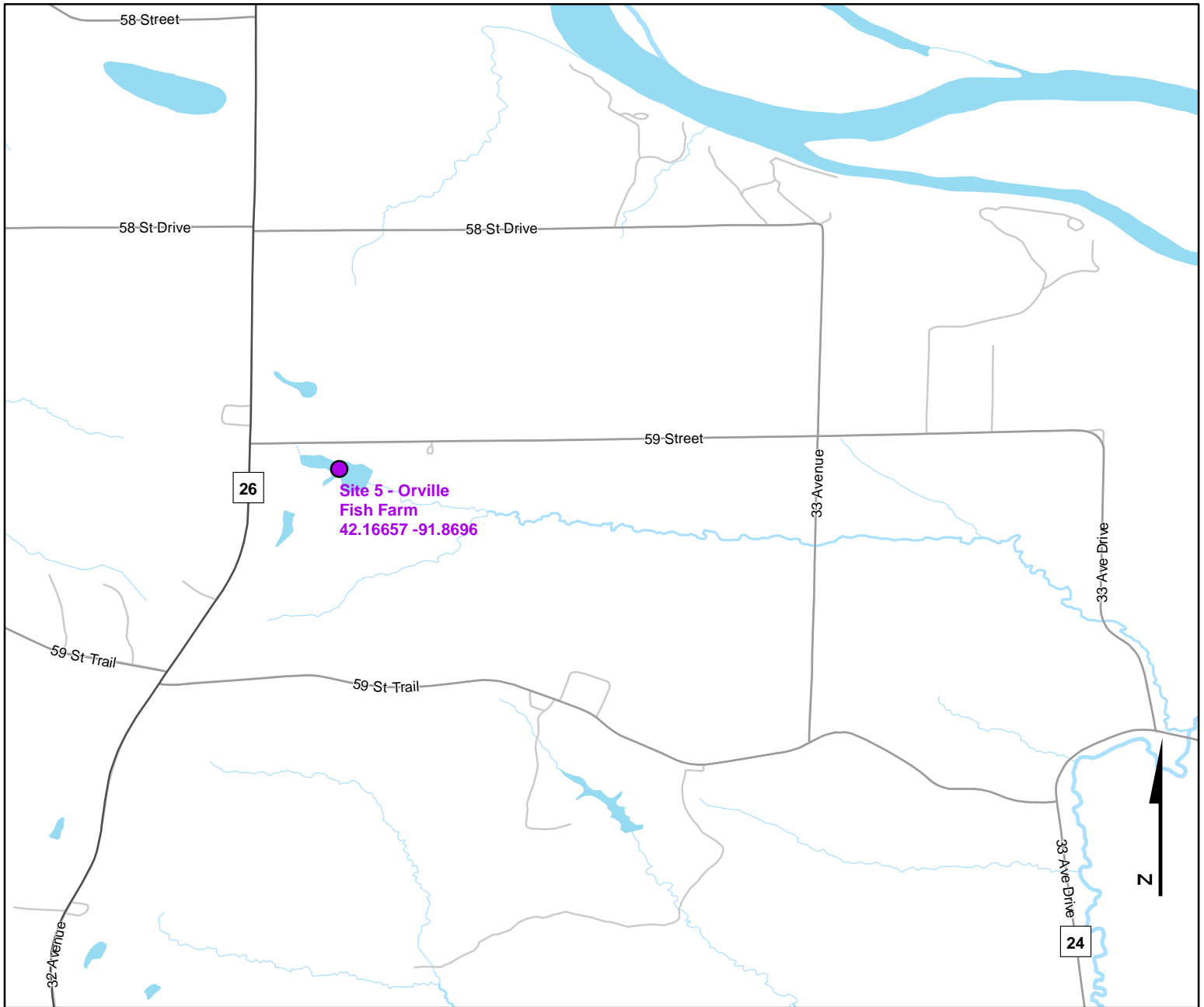

## Legend

----- Trails

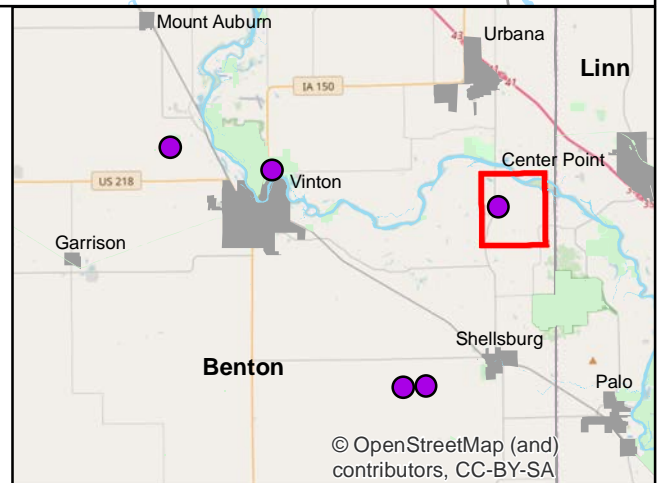



# Frog and Toad Call Survey Route Description

Route ID **159**

Established: 1995

Site Number	Name	County	Latitude	Longitude	Directions
1	Dudgeon Marsh Area	Benton	42.1853619	-92.0145953	Take 150 north out of Vinton and then east on E16, 2nd access on north
2	RODGER'S 2	Benton	42.1969168	-92.0796388	
3	WILDCAT CREEK	Benton	42.0810616	-91.9322588	Prairie and softwood border, meandering.
4	CANTON DITCH	Benton	42.0814546	-91.9174934	Roadside ditch at same property as Wildcat Creek.
5	Orville Fish Farm	Benton	42.1665707	-91.8696012	Outlet for Fish Farm, Just east of 59th and 32nd St. Intersection